

# PAPERBOX



# LOFTS



## Where Location Meets Luxury Living

### COMMUNITY FEATURES

- 7 Story Mechanical Lift & Underground Parking w/EV Charging
- Spacious Loft Style Live-Work Apartment Homes
- Clubhouse w/Gaming Center
- Luxury Suites w/ Direct Elevator Access
- The Overlook Outdoor Kitchen
- Rooftop Zen Lounge
- The Locker Room Sports Lounge
- Outdoor Lounge w/Fire Table
- 24/7 Fitness Center
- Conference Room
- Hydro Massage Bed
- Spruce - Cleaning & Concierge Services
- RentPlus Credit Builder
- Controlled Access Community
- 24/7 Package Hub Service
- Walking Distance to Nearby Restaurants, Shopping, & More
- Smoke Free Community
- Central Heat & Air
- Community Courtyard
- High Speed Internet
- Pet Friendly Community
- Short-Term Fully Furnished Rentals Available
- Onsite 24 Hour Market
- Optional TheGuarantors Rent Guarantee Program

### APARTMENT FEATURES

- High End Finishes
- Unique Floor Plans
- Floor To Ceiling Windows
- Smart Home Powered By Dwelo
- High Ceilings
- Walk-In Closets\* More info on Walk-In Closets\*
- Stainless Steel Energy Efficient Appliances
- Washers & Dryers In Every Home
- Extra Storage Available For Rent
- Juliet & Large Balconies
- City & Mountain Views



### COMMUNITY HIGHLIGHTS



Studio, 1, & 2  
Bedrooms



1-2 Bathrooms



In-Unit Laundry



388-1,761 SQ. FT.



160 S. 300 W.  
Salt Lake City, UT 84101



PaperboxLofts.com



888.507.9475





# STUDIOS



**PICASSO BLEU**  
STUDIO X 1 BATH  
496-512 SF



**PICASSO ROUGE**  
STUDIO X 1 BATH  
496 SF



**PICASSO JUENE**  
STUDIO X 1 BATH  
583 SF

# 1-BEDROOMS



**MONET BLEU**  
1 BED X 1 BATH  
660 SF



**MONET ROUGE**  
1 BED X 1 BATH  
668-678 SF



**MONET JUENE**  
1 BED X 1 BATH  
729-739 SF

# 2-BEDROOMS



**DALI ROUGE**  
2 BED X 2 BATH  
894-907 SF

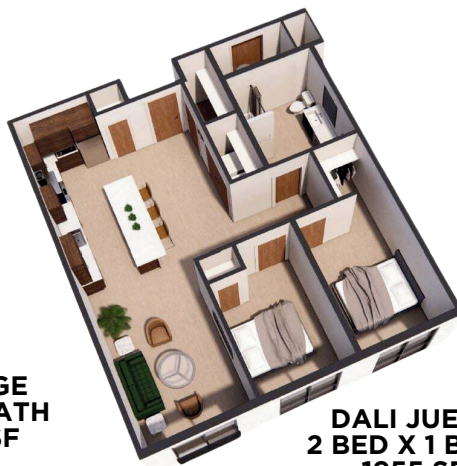

**DALI JUENE**  
2 BED X 1 BATH  
1955 SF



**DALI BLEU**  
2 BED X 1 BATH  
1,015 SF

*\*All renderings & square footages are approximations. Floor plan sizes & finishes may vary.*



160 S. 300 W.  
Salt Lake City, UT 84101



PaperboxLofts.com



888.507.9475





# Living Made Simple

## Your Guide to Pricing & Fees

FLOOR PLAN	SIZE (SQ. FT.)	MAX OCCUPANCY	RENTAL RATE (Rent Only)
STUDIO   1 BATH	388-683 SQ. FT.	2 OCCUPANTS	\$1,525-\$1,550
1 BED   1 BATH	660-860 SQ. FT.	2 OCCUPANTS	\$1,259-\$1,785
2 BED   1 BATH	728-1,020 SQ. FT.	4 OCCUPANTS	\$1,499-\$1,649
2 BED   2 BATH	894-1,761 SQ. FT.	4 OCCUPANTS	\$1,599-\$1,749

### SPECIALS (IF APPLICABLE):

\*\*\*

\*Restrictions May Apply- Pricing and Specials Change Daily. Ask a team member for more details.

### ONE-TIME FEES:

APPLICATION FEE:	\$45/Applicant
ADMIN FEE (NON-REFUNDABLE):	\$275
SECURITY DEPOSIT (REFUNDABLE):	\$500- \$1,000 OAC
PET FEE (OPTIONAL - NON-REFUNDABLE):	\$500/Pet

### RECURRING FEES:

SMART HOME PACKAGE:	\$160/mo
• Includes 1 Gbps Internet & Smart Home Hardware & Software & PDK access.	
UTILITIES (BASED ON USAGE):	
• Residents are responsible for setting up and maintaining electricity in their name to be paid directly to the service provider. Water, sewage, trash, CAM fees and pest control will be billed monthly in addition to rent. Rents are based on usage, square footage and total occupants.	
PET FEES (OPTIONAL):	\$50/mo/pet
PARKING:	\$95/mo Mechanical Lift Parking
OR	\$115/mo Gateway Garage Parking
OR	\$135/mo Garage Mechanical Lift Parking
OR	\$190/mo Garage EV Parking
STORAGE (OPTIONAL):	\$25-75/mo Depending on Size of Unit

### RENTER'S INSURANCE & RESIDENT INDEMNITY PROGRAM

Residents are required to maintain renter's insurance with a minimum liability of \$100,000 in liability coverage. Otherwise, residents will be automatically enrolled in our Resident Indemnity Program, which provides building coverage for \$15 per month.

### BACKGROUND CHECK

Applicants are subject to a background check and credit screening to validate qualification of residence. Based on the results, your application will be approved, denied, or approved with conditions.

\*Pricing & fees are subject to change at any time. Contact leasing office for more info.



160 S. 300 W.  
Salt Lake City, UT 84101



PaperboxLofts.com



888.507.9475

